

M VD12 1/2 BSP E DIN 3852-2-A *

Codice articolo: 809500005 / Male / *Prodotto disponibile su richiesta

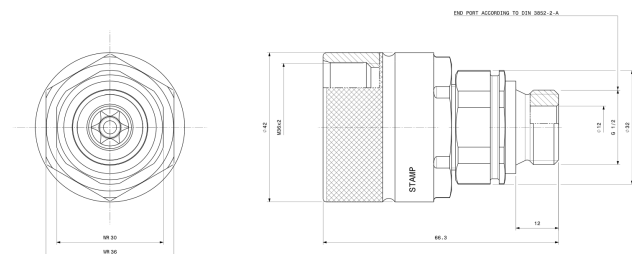

Isometric view
Scale 1:1



Body size 1/2"	Valving style Poppet
Interchange ISO 14541	Sealing Nitrile NBR
Connection system Screw	Disconnection system Unscrew
Material Carbon steel	Treatment Cr3
Locking mechanism Screw to connect	Disconnectable under pressure No
Thread FEMALE THREAD BSPP (ISO 1179-1)	Connectable under residual pressure Pressure in one side
Temperature -20 / +100 °C; -4 / +212 °F	Applications Earth moving, Vehicles, Hydraulic Tools

Performance

	METRIC
ISO DN (mm)	12.5
Flow (l/min)	Da 50 a 150
Max. Flow suggested (l/min)	90
Max. Operating pressure - coupled (Mpa)	40
Operating pressure - uncoupled (mpa)	40
Burst pressure - coupled (mpa)	140
Burst pressure - uncoupled (mpa)	120
Spillage (ml)	3
Manual connect torque (Nm)	1.5
Manual disconnect torque (Nm)	1.2

Dimensions

	METRIC
Port (A)	1/2"
Overall length M+F (mm)	115,6
Length (mm)	66,3
Max. diameter (mm)	42
Weight (kg)	0,27

Related products

Product code	Type	Product name
809500004	Femmina	F VD12 1/2 BSP E DIN 3852-2-A

Caps

Product code	Product name
814900005	PLASTIC CAP M VD12 RED