

GR6 6B-2EC

Previous description	Max. Resistance	FAP9 (A)	FAP13 (B)	FAP15 (C)	FAP17 (D)	FAP21 (E)	FAP30 (G)
Body size		3/8"	1/2"	5/8"	3/4"	1"	1-1/2"
GR6-13ZN	23000 N		6				

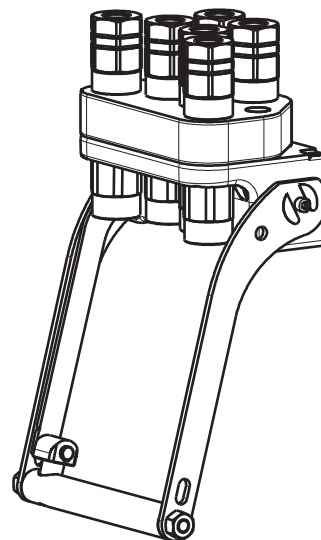

DRAWING



CONFIGURATIONS

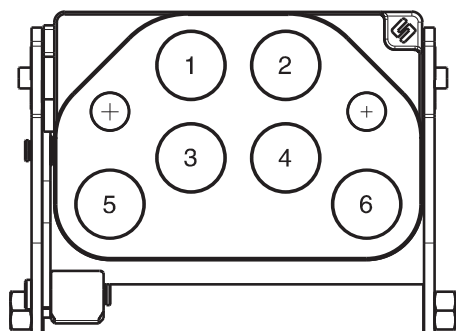

Possible configurations		
Pos	Coupling size	Predisposition for electrical connector
1	FAP13ZN	-
2	FAP13ZN	-
3	FAP13ZN	-
4	FAP13ZN	-
5	FAP13ZN	YES
6	FAP13ZN	YES

MultiCoupling (couplings included)		
Code	Name	Description
870002030	MULTI COMPLETE GR6 6B	6 FAP13 3/4 BSP - CAP
870002031	MULTI COMPLETE GR6 6B	6 FAP13 1/2 BSP - CAP
870002130	MULTI FIX GR6 6B	6 FAP13 3/4 BSP
870002131	MULTI FIX GR6 6B	6 FAP13 1/2 BSP
870002209	MULTI MOBILE GR6 2B	2 FAP13 3/4 BSP
870002230	MULTI MOBILE GR6 6B	6 FAP13 3/4 BSP
870002231	MULTI MOBILE GR6 6B	6 FAP13 1/2 BSP

MultiCoupling spare parts (couplings not included)		
Code	Name	
806000292	MULTI FIX EMPTY GR6 6B-2EC	
806000293	MULTI MOBILE EMPTY GR6 6B-2EC	
815606256	CAP FIX MULTICOUPLING GR 175x117	
815606257	PARKING STATION MOBILE MULTICOUPLING GR 180x120	
815700999	SPARE KIT LEVER GROUP GR 250x212	

Custom configurations available upon request

Fixed and mobile multicoupling

5,8 Kg and 2,7 Kg

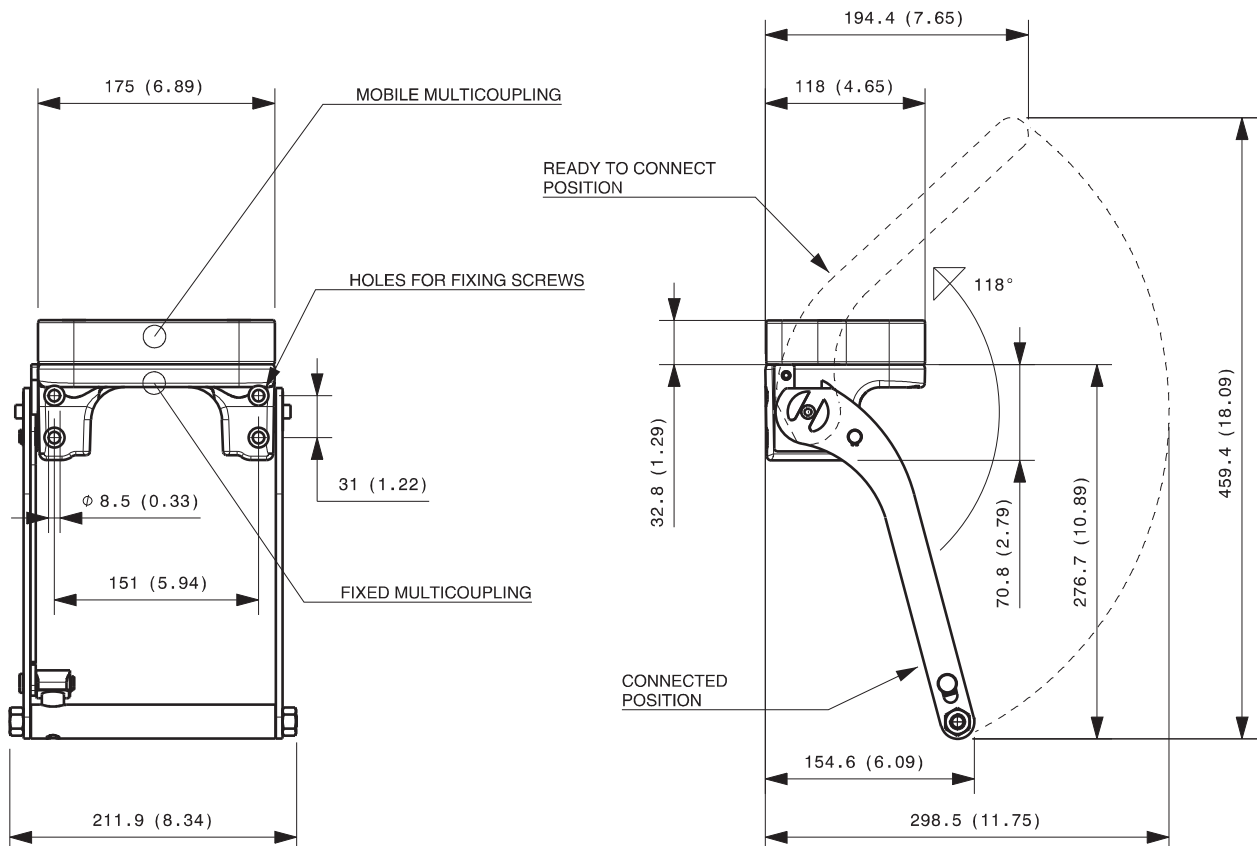

Dimensions in millimeters (inch)

Cap for fixed multicoupling 1,1 Kg

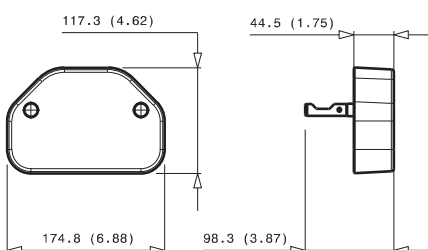

Parking station for mobile multicoupling 2,2 Kg

