

GR6 4B-2D-4EC

Previous description	Max. Resistance Body size	FAP9 (A) 3/8"	FAP13 (B) 1/2"	FAP15 (C) 5/8"	FAP17 (D) 3/4"	FAP21 (E) 1"	FAP30 (G) 1-1/2"
GR6ABZN	23000 N		4		2		

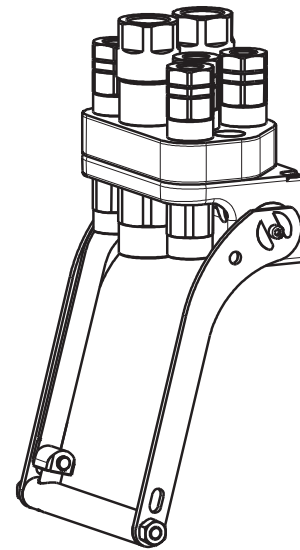

DRAWING



CONFIGURATIONS

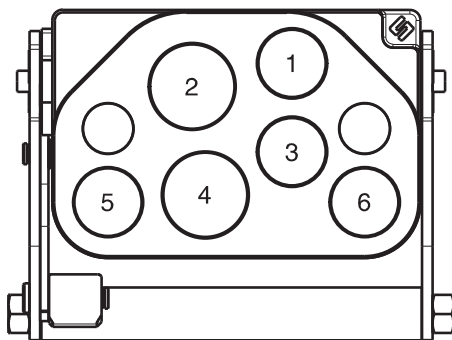

Possible configurations		
Pos	Coupling size	Predisposition for electrical connector
1	FAP13ZN	YES
2	FAP17ZN	-
3	FAP13ZN	YES
4	FAP17ZN	-
5	FAP13ZN	YES
6	FAP13ZN	YES

MultiCoupling (couplings included)		
Code	Name	Description
870015073	MULTI COMPLETE GR6 4B-2D	4 FAP13 1/2 BSP - 2 FAP17 3/4 BSP - CAP
870016031	MULTI COMPLETE GR6 2B 2D 2EC	2 FAP13 1/2 BSP - 2 FAP17 1 BSP - 2EC7 - CAP
870016036	MULTI COMPLETE GR6 4B-2D	2 FAP13 1/2 BSP - 2 FAP13 3/4 BSP - 1 FAP17 3/4 BSP - 1 FAP17 1 BSP - CAP
870015173	MULTI FIX GR6 4B-2D	4 FAP13 1/2 BSP - 2 FAP17 3/4 BSP
870016131	MULTI FIX GR6 2B 2D 2EC	2 FAP13 1/2 BSP - 2 FAP17 1 BSP - 2EC7
870016149	MULTI FIX GR6 4B-2D	2 FAP13 1/2 BSP - 2 FAP13 3/4 BSP - 2 FAP17 1 BSP
870015273	MULTI MOBILE GR6 4B-2D	4 FAP13 1/2 BSP - 2 FAP17 3/4 BSP
870016231	MULTI MOBILE GR6 2B 2D 2EC	2 FAP13 1/2 BSP - 2 FAP17 1 BSP - 2EC7
870016249	MULTI MOBILE GR6 4B-2D	2 FAP13 1/2 BSP - 2 FAP13 3/4 BSP - 2 FAP17 1 BSP

MultiCoupling spare parts (couplings not included)	
Code	Name
80600322	MULTI FIX EMPTY GR6 4B-2D-4EC
80600323	MULTI MOBILE EMPTY GR6 4B-2D-4EC
815606260	CAP FIX MULTICOUPLING GR 175x117 V02
815606261	PARKING STATION MOBILE MULTICOUPLING GR 180x120 V02
815701055	SPARE KIT LEVER GROUP GR 250x212

Custom configurations available upon request

Fixed and mobile multicoupling

5,4 Kg and 2,6 Kg

GR

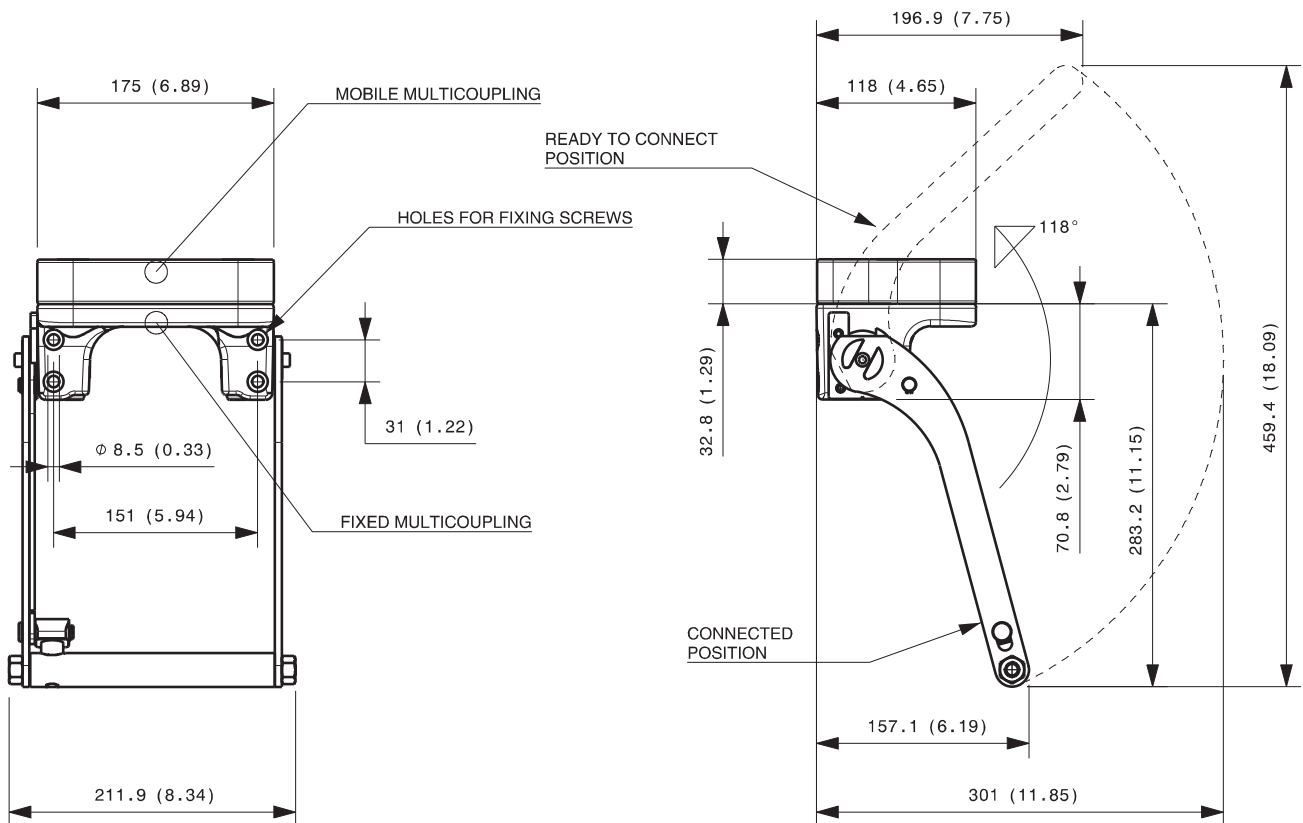

Dimensions in millimeters (inch)

Cap for fixed multicoupling 1,2 Kg

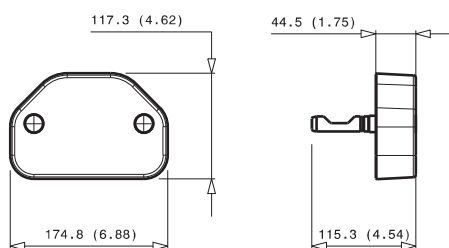

Parking station for mobile multicoupling 2,4 Kg

