

GR6 4A-2B-2EC

Previous description	Max. Resistance	FAP9 (A)	FAP13 (B)	FAP15 (C)	FAP17 (D)	FAP21 (E)	FAP30 (G)
Body size		3/8"	1/2"	5/8"	3/4"	1"	1-1/2"
GRT6ZN	23000 N	4 D	2				

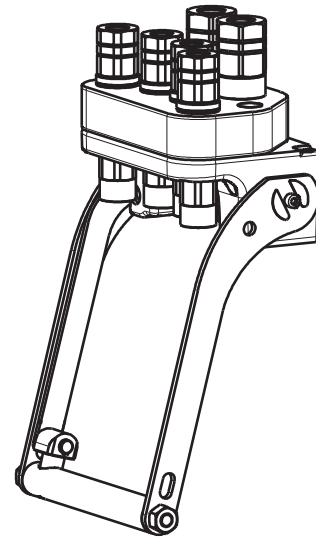

DRAWING



CONFIGURATIONS

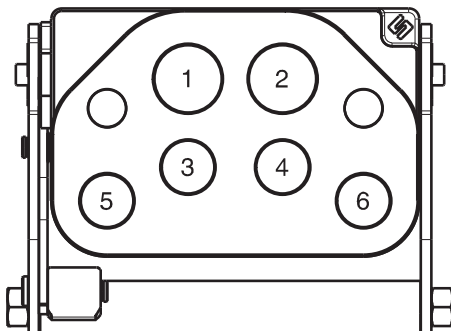

Possible configurations		
Pos	Coupling size	Predisposition for electrical connector
1	FAP13ZN	-
2	FAP13ZN	-
3	FAP9DZN	-
4	FAP9DZN	-
5	FAP9DZN	YES
6	FAP9DZN	YES

MultiCoupling (couplings included)		
Code	Name	Description
870015064	MULTI COMPLETE GR6 4A-2B	4 FAP9D 1/2 BSP - 2 FAP13 3/4 BSP - CAP
870016002	MULTI COMPLETE GR6 4A-2B	4 FAP9D 3/8 BSP - 2 FAP13 3/4 BSP - CAP
870016032	MULTI COMPLETE GR6 2A 2B	2 FAP9D 3/8 BSP - 2 FAP13 1/2 BSP - CAP
870016034	MULTI COMPLETE GR6 2A-2B-2EC	2 FAP9D 3/8 BSP - 2 FAP13 1/2 BSP - 2 EC6 - CAP
870016013	MULTI COMPLETE GR6 4A-1B	4 FAP9DZ 1/4 BSP - 1 FAP13ZN 1/2 BSP
870015190	MULTI FIX GR6 4A-2B	4 FAP9D 3/8 BSP - 1 FAP13 1/2 BSP - 1 FAP13 3/4 BSP
870016132	MULTI FIX GR6 2A 2B	2 FAP9D 3/8 BSP - 2 FAP13 1/2 BSP
870016134	MULTI FIX GR6 2A-2B-2EC	2 FAP9D 3/8 BSP - 2 FAP13 1/2 BSP - 2 EC6
870015290	MULTI MOBILE GR6 4A-2B	4 FAP9D 3/8 BSP - 1 FAP13 1/2 BSP - 1 FAP13 3/4 BSP
870016232	MULTI MOBILE GR6 2A 2B	2 FAP9D 3/8 BSP - 2 FAP13 1/2 BSP
870016234	MULTI MOBILE GR6 2A-2B-2EC	2 FAP9D 3/8 BSP - 2 FAP13 1/2 BSP - 2 EC6

MultiCoupling spare parts (couplings not included)	
Code	Name
806000294	MULTI FIX EMPTY GR6 4A-2B-2EC
806000295	MULTI MOBILE EMPTY GR6 4A-2B-2EC
815606256	CAP FIX MULTICOUPLING GR 175x117
815606257	PARKING STATION MOBILE MULTICOUPLING GR 180x120
815700999	SPARE KIT LEVER GROUP GR 250x212

Custom configurations available upon request

Fixed and mobile multicoupling

5,9 Kg and 2,8 Kg

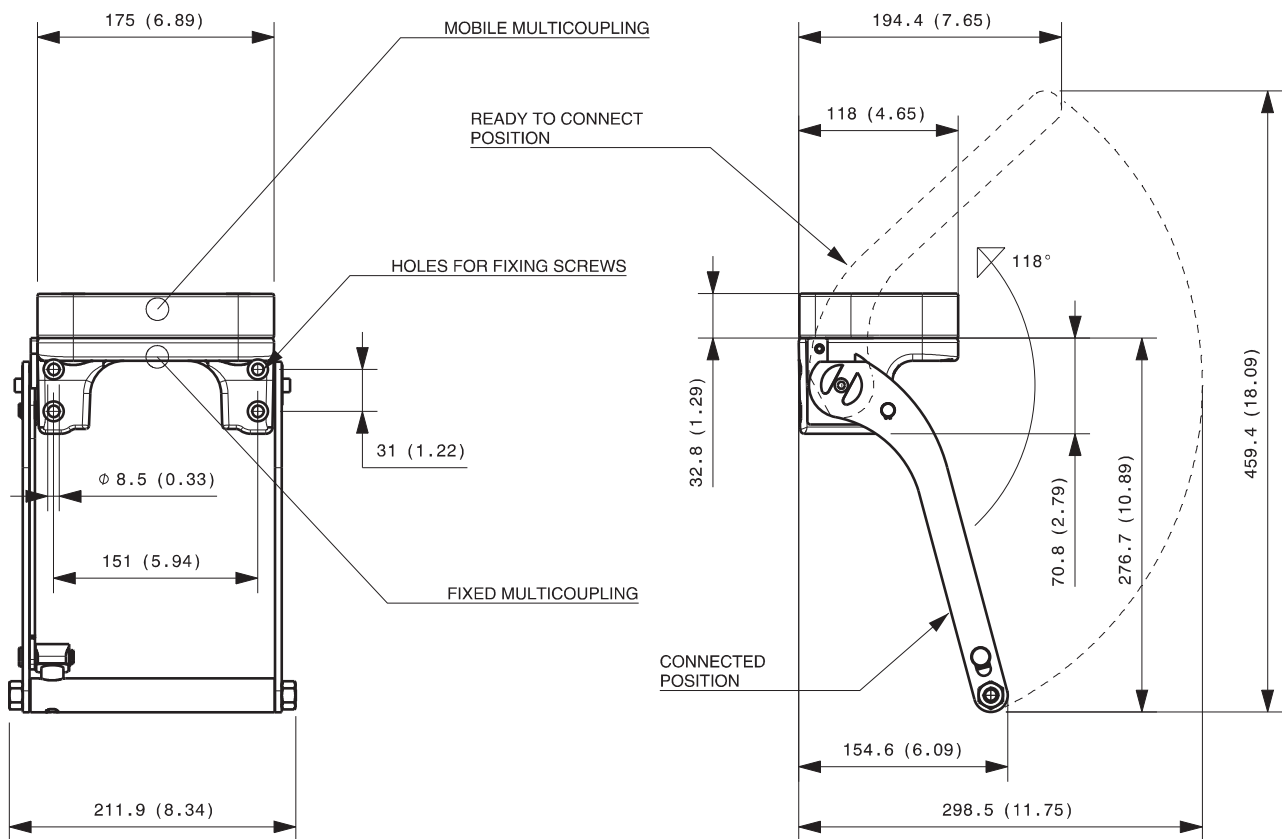

Dimensions in millimeters (inch)

Cap for fixed multicoupling 1,1 Kg

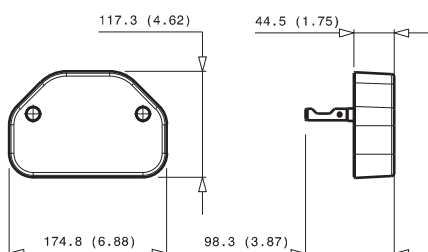

Parking station for mobile multicoupling 2,2 Kg

