

GR4 2A-2B-2EC

| Previous description | Max. Resistance | FAP9 (A) | FAP13 (B) | FAP15 (C) | FAP17 (D) | FAP21 (E) | FAP30 (G) |
|----------------------|-----------------|----------|-----------|-----------|-----------|-----------|-----------|
| Body size | | 3/8" | 1/2" | 5/8" | 3/4" | 1" | 1-1/2" |
| GRB4ZN | 18000 N | 2 D | 2 | | | | |

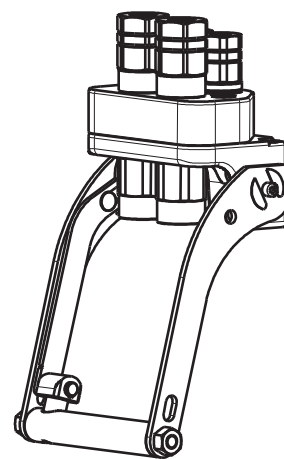

DRAWING



CONFIGURATIONS

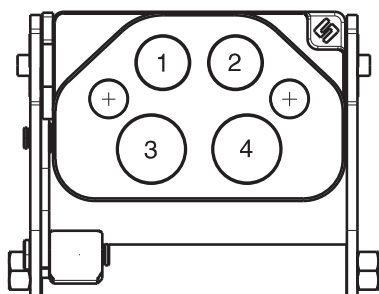

| Possible configurations | | |
|-------------------------|---------------|---|
| Pos | Coupling size | Predisposition for electrical connector |
| 1 | FAP9DZN | YES |
| 2 | FAP9DZN | YES |
| 3 | FAP13ZN | - |
| 4 | FAP13ZN | - |

MultiCoupling (couplings included)

| Code | Name | Description |
|-----------|--------------------------|---|
| 870016014 | MULTI COMPLETE GR4 2A-2B | 2 FAP9D 3/8 BSP - 2 FAP13 1/2 BSP - CAP |
| 870016114 | MULTI FIX GR4 2A-2B | 2 FAP9D 3/8 BSP - 2 FAP13 1/2 BSP |
| 870016214 | MULTI MOBILE GR4 2A-2B | 2 FAP9D 3/8 BSP - 2 FAP13 1/2 BSP |

MultiCoupling spare parts (couplings not included)

| Code | Name |
|-----------|---|
| 806000274 | MULTI FIX EMPTY GR4 2A-2B-2EC |
| 806000275 | MULTI MOBILE EMPTY GR4 2A-2B-2EC |
| 815606248 | CAP FIX MULTICOUPLING GR 139x90 |
| 815606249 | PARKING STATION MOBILE MULTICOUPLING GR 140x100 |
| 815701052 | SPARE KIT LEVER GROUP GR 200x176 |

Custom configurations available upon request

Fixed and mobile multicoupling

3,7 Kg and 1,8 Kg

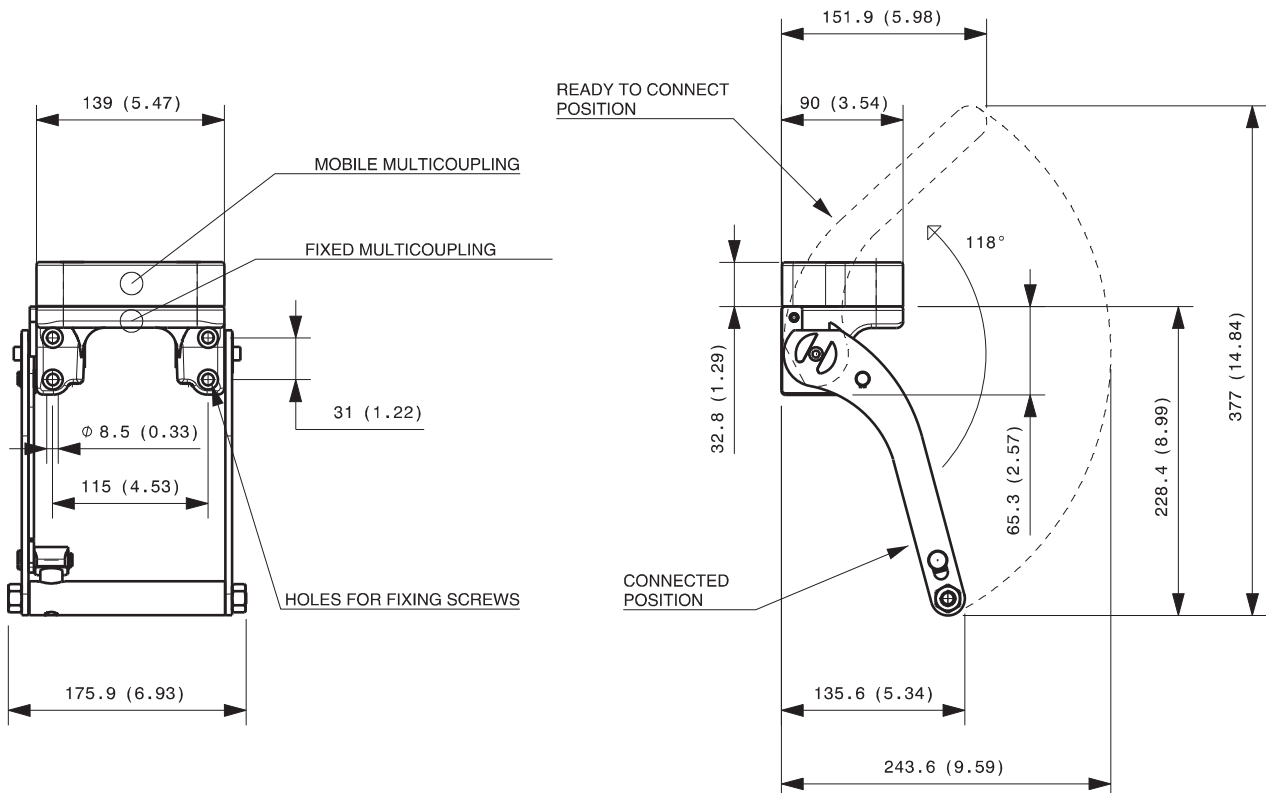

Dimensions in millimeters (inch)

Cap for fixed multicoupling 0,6 Kg

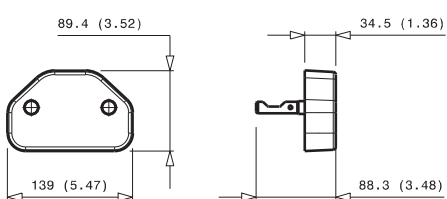

Parking station for mobile multicoupling 1,1 Kg

