

# DP3 2A-1EC

| Previous description | Max. Resistance | FAP9 (A) | FAP13 (B) | FAP15 (C) | FAP17 (D) | FAP21 (E) | FAP30 (G) |
|----------------------|-----------------|----------|-----------|-----------|-----------|-----------|-----------|
| Body size            |                 | 3/8"     | 1/2"      | 5/8"      | 3/4"      | 1"        | 1-1/2"    |
| DPJ3ZN               | 8000 N          | 2        | A         |           |           |           |           |

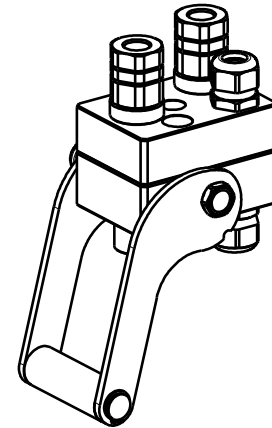

## DRAWING



## CONFIGURATIONS

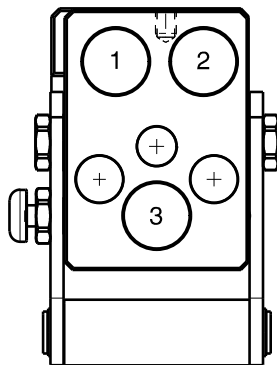

| Possible configurations |               |   |
|-------------------------|---------------|---|
| Pos                     | Coupling size | Predisposition for electrical connector |
| 1                       | FAP9AZN       | -                                       |
| 2                       | -             | YES                                     |
| 3                       | FAP9AZN       | -                                       |

### MultiCoupling (couplings included)

| Code      | Name                      | Description                  |
|-----------|---------------------------|------------------------------|
| 870009016 | MULTI COMPLETE DP3 2A-1EC | 2 FAP9A 3/8 BSP - 1EC6 - CAP |
| 870009116 | MULTI FIX DP3 2A-1EC      | 2 FAP9A 3/8 BSP - 1EC6       |
| 870009216 | MULTI MOBILE DP3 2A-1EC   | 2 FAP9A 3/8 BSP - 1EC6       |

### MultiCoupling spare parts (couplings not included)

| Code      | Name   |
|-----------|--|
| 806000358 | MULTI FIX EMPTY DP3 2A-1EC                     |
| 806000359 | MULTI MOBILE EMPTY DP3 2A-1EC                  |
| 815606274 | CAP FIX MULTICOUPLING DP 99x70                 |
| 815606275 | PARKING STATION MOBILE MULTICOUPLING DP 100x70 |
| 815701083 | SPARE KIT LEVER GROUP DP 130x87                |

Custom configurations available upon request

