

DP3 1A-2C-1EC V04

| Previous description | Max. Resistance | FAP9 (A) | FAP13 (B) | FAP15 (C) | FAP17 (D) | FAP21 (E) | FAP30 (G) |
|----------------------|-----------------|----------|-----------|-----------|-----------|-----------|-----------|
| Body size | 10000 N | 3/8" | 1/2" | 5/8" | 3/4" | 1" | 1-1/2" |
| | | 1 | D | 2 | | | |

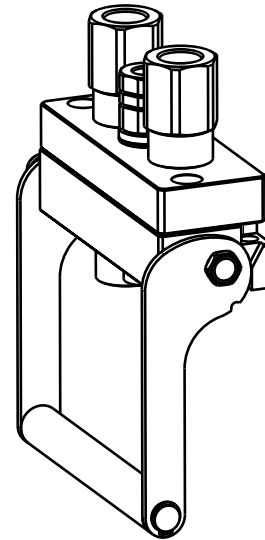

DRAWING



CONFIGURATIONS

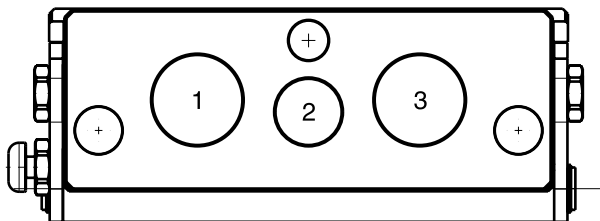

| Possible configurations | | |
|-------------------------|---------------|-----------------------------------------|
| Pos | Coupling size | Predisposition for electrical connector |
| 1 | FAP15 | - |
| 2 | FAP9-D | YES |
| 3 | FAP15 | - |

| MultiCoupling (couplings included) | | |
|------------------------------------|------------------------------|-----------------------------------------|
| Code | Name | Description |
| 870008027 | MULTI COMPLETE DP3 1A-2C V04 | 1 FAP9D 3/8 BSP - 2 FAP15 3/4 BSP - CAP |
| 870008127 | MULTI FIX DP3 1A-2C V04 | 1 FAP9D 3/8 BSP - 2 FAP15 3/4 BSP |
| 870008130 | MULTI FIX DP3 1A-2C V04 | 1 FAP9D 1/2 BSP - 2 FAP15 3/4 BSP |
| 870008227 | MULTI MOBILE DP3 1A-2C V04 | 1 FAP9D 3/8 BSP - 2 FAP15 3/4 BSP |
| 870008230 | MULTI MOBILE DP3 1A-2C V04 | 1 FAP9D 1/2 BSP - 2 FAP15 3/4 BSP |

| MultiCoupling spare parts (couplings not included) | |
|----------------------------------------------------|------------------------------------------------|
| Code | Name |
| 806000416 | MULTI FIX EMPTY DP3 1A-2C-1EC V04 |
| 806000417 | MULTI MOBILE EMPTY DP3 1A-2C-1EC V04 |
| 815606314 | CAP FIX MULTICOUPLING DP 185x69 |
| 815606315 | PARKING STATION MOBILE MULTICOUPLING DP 185x69 |

Custom configurations available upon request

Fixed and mobile multicoupling

2,3 Kg and 0,9 Kg

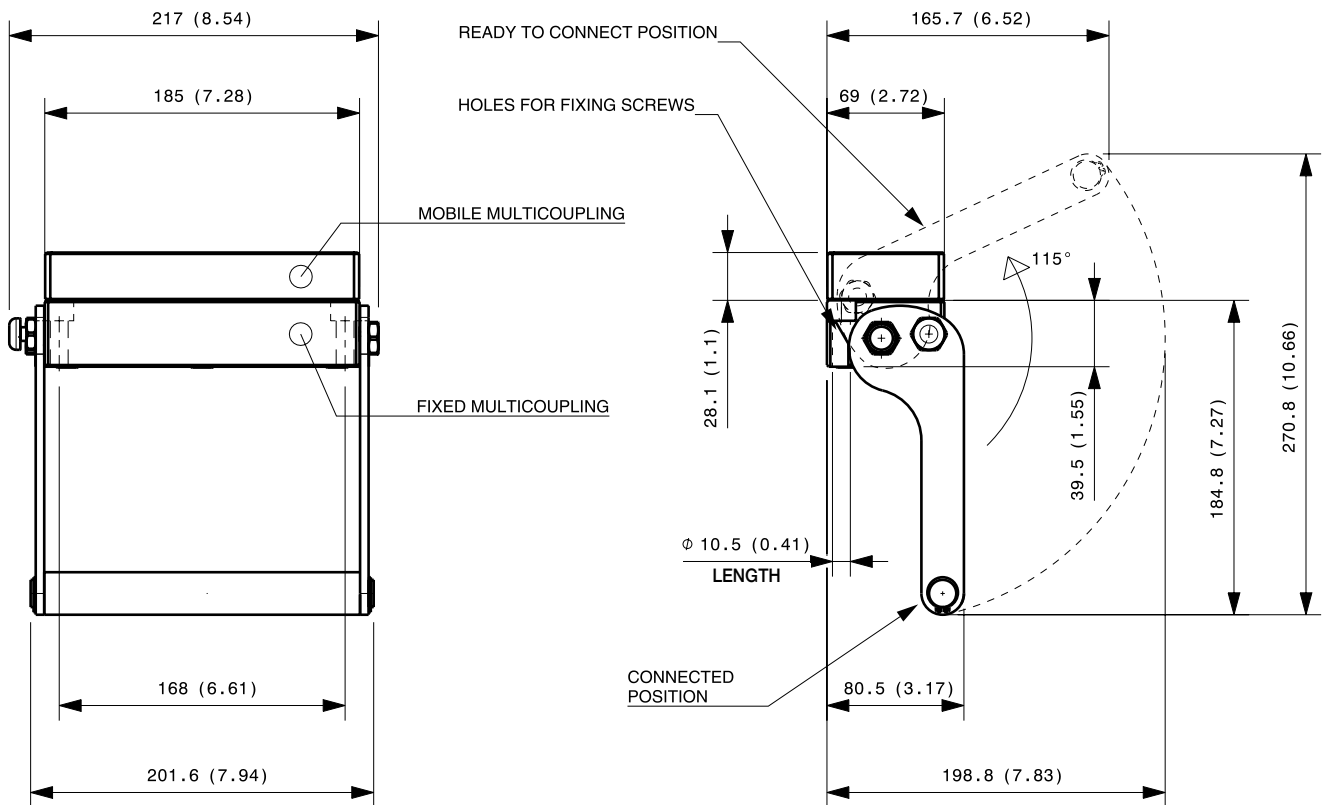

Dimensions in millimeters (inch)

Cap for fixed multicoupling 0,9 Kg

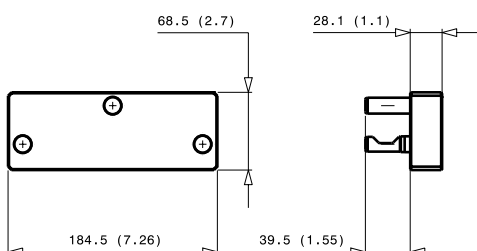

Parking station for mobile multicoupling 3,3 Kg

