

# GR6 4B-2D-4EC

Previous description	Max. Resistance	FAP9 (A)	FAP13 (B)	FAP15 (C)	FAP17 (D)	FAP21 (E)	FAP30 (G)
Body size		3/8"	1/2"	5/8"	3/4"	1"	1-1/2"
GR6ABZN	23000 N		4		2		

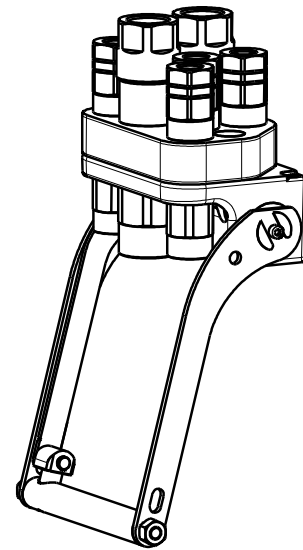

## DRAWING



## CONFIGURATIONS

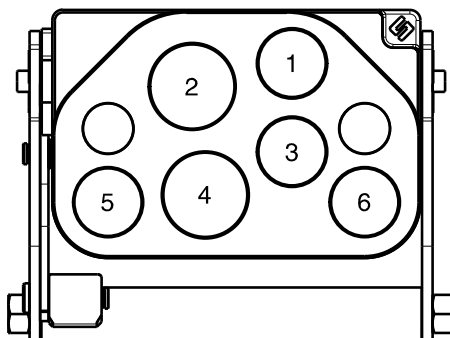

Possible configurations		
Pos	Coupling size	Predisposition for electrical connector
1	FAP13ZN	YES
2	FAP17ZN	-
3	FAP13ZN	YES
4	FAP17ZN	-
5	FAP13ZN	YES
6	FAP13ZN	YES

MultiCoupling (couplings included)		
Code	Name	Description
870015073	MULTI COMPLETE GR6 4B-2D	4 FAP13 1/2 BSP - 2 FAP17 3/4 BSP - CAP
870016031	MULTI COMPLETE GR6 2B 2D 2EC	2 FAP13 1/2 BSP - 2 FAP17 1 BSP - 2EC7 - CAP
870016036	MULTI COMPLETE GR6 4B-2D	2 FAP13 1/2 BSP - 2 FAP13 3/4 BSP - 1 FAP17 3/4 BSP - 1 FAP17 1 BSP - CAP
870016063	MULTI COMPLETE GR6 4B-2D	4 FAP13 1/2 NPT - 2 FAP17 3/4 NPT - CAP
870015173	MULTI FIX GR6 4B-2D	4 FAP13 1/2 BSP - 2 FAP17 3/4 BSP
870016131	MULTI FIX GR6 2B 2D 2EC	2 FAP13 1/2 BSP - 2 FAP17 1 BSP - 2EC7
870016149	MULTI FIX GR6 4B-2D	2 FAP13 1/2 BSP - 2 FAP13 3/4 BSP - 2 FAP17 1 BSP
870015273	MULTI MOBILE GR6 4B-2D	4 FAP13 1/2 BSP - 2 FAP17 3/4 BSP
870016231	MULTI MOBILE GR6 2B 2D 2EC	2 FAP13 1/2 BSP - 2 FAP17 1 BSP - 2EC7
870016249	MULTI MOBILE GR6 4B-2D	2 FAP13 1/2 BSP - 2 FAP13 3/4 BSP - 2 FAP17 1 BSP

MultiCoupling spare parts (couplings not included)		
Code	Name	
806000322	MULTI FIX EMPTY GR6 4B-2D-4EC	
806000323	MULTI MOBILE EMPTY GR6 4B-2D-4EC	
815606260	CAP FIX MULTICOUPLING GR 175x117 V02	
815606261	PARKING STATION MOBILE MULTICOUPLING GR 180x120 V02	
815701055	SPARE KIT LEVER GROUP GR 250x212	

Custom configurations available upon request

## Fixed and mobile multicoupling

5,4 Kg and 2,6 Kg

GR

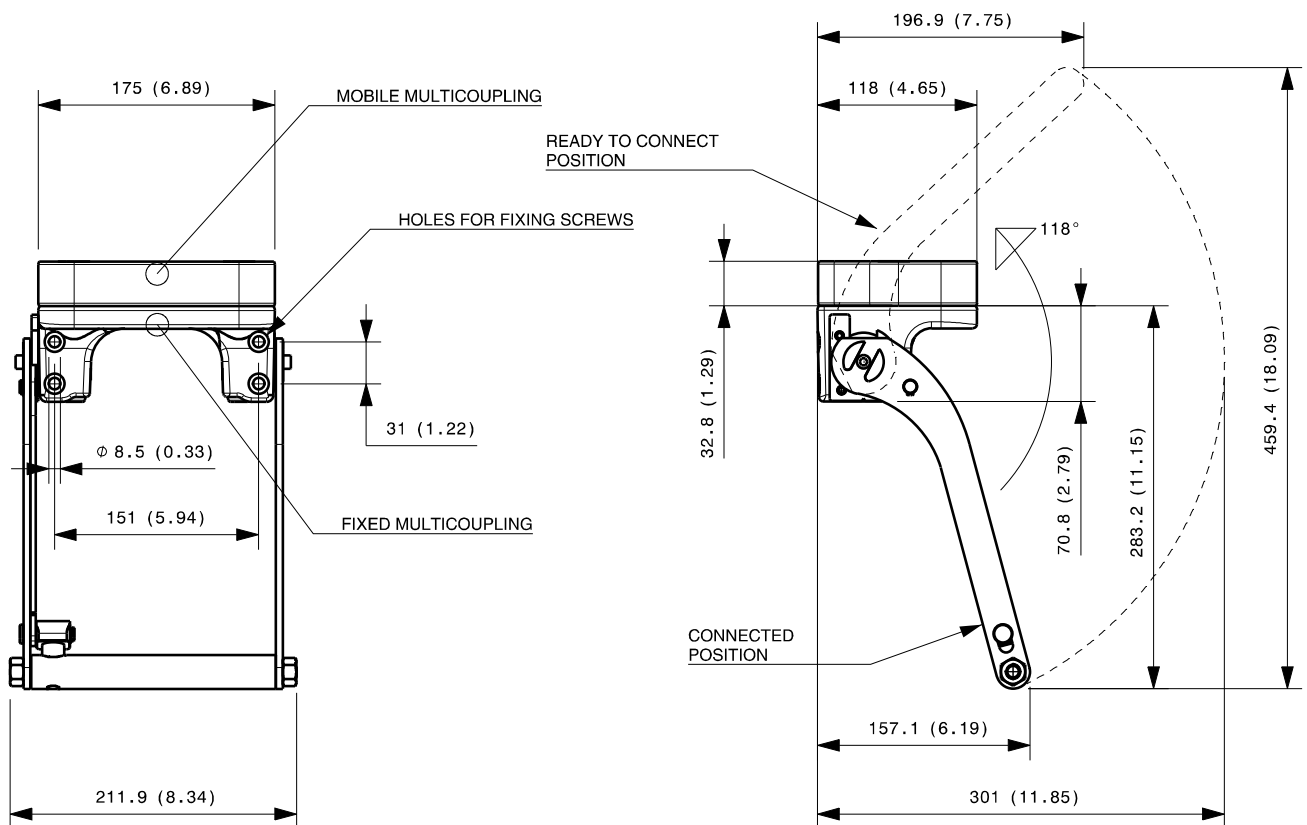

Dimensions in millimeters (inch)

### Cap for fixed multicoupling 1,2 Kg

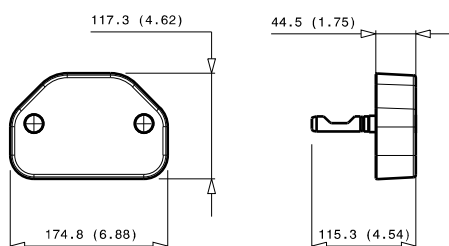

### Parking station for mobile multicoupling 2,4 Kg

