

GR5 5C

Previous description	Max. Resistance	FAP9 (A)	FAP13 (B)	FAP15 (C)	FAP17 (D)	FAP21 (E)	FAP30 (G)
Body size		3/8"	1/2"	5/8"	3/4"	1"	1-1/2"
GR5-15ZN	23000 N			5			



DRAWING



CONFIGURATIONS

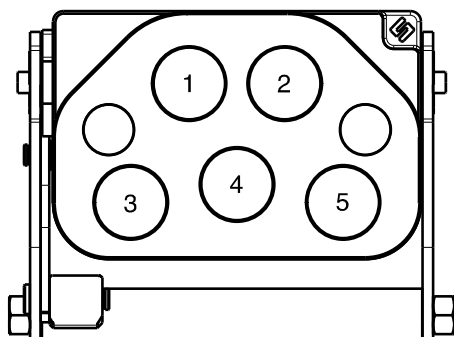

Possible configurations		
Pos	Coupling size	Predisposition for electrical connector
1	FAP15ZN	-
2	FAP15ZN	-
3	FAP15ZN	*
4	FAP15ZN	-
5	FAP15ZN	*

* upon request

MultiCoupling (couplings included)		
Code	Name	Description
870016010	MULTI COMPLETE GR5 5C	5 FAP15 3/4 BSP - CAP
870016110	MULTI FIX GR5 5C	5 FAP15 3/4 BSP
870016210	MULTI MOBILE GR5 5C	5 FAP15 3/4 BSP

MultiCoupling spare parts (couplings not included)	
Code	Name
806000326	MULTI FIX EMPTY GR5 5C
806000327	MULTI MOBILE EMPTY GR5 5C
815606260	CAP FIX MULTICOUPLING GR 175x117 V02
815606261	PARKING STATION MOBILE MULTICOUPLING GR 180x120 V02
815701055	SPARE KIT LEVER GROUP GR 250x212

Custom configurations available upon request

Fixed and mobile multicoupling

5,6 Kg and 2,8 Kg

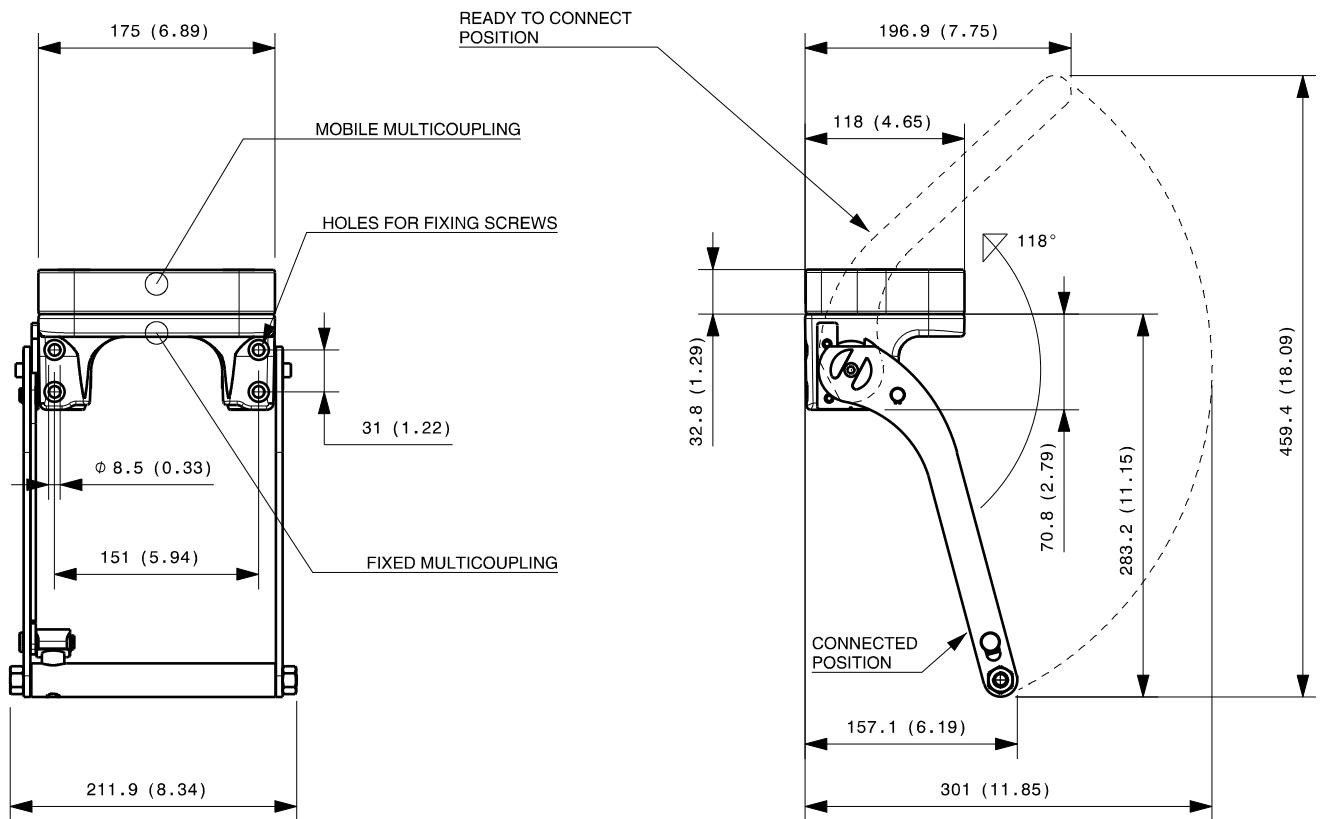

Dimensions in millimeters (inch)

Cap for fixed multicoupling 1,2 Kg

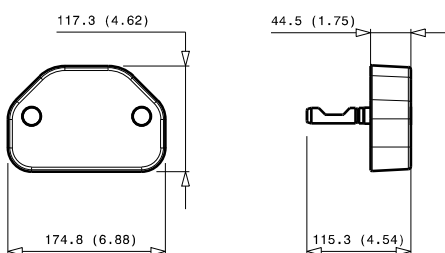

Parking station for mobile multicoupling 2,4 Kg

