

GR5 3A-1D-1E-2EC

Previous description	Max. Resistance	FAP9 (A)	FAP13 (B)	FAP15 (C)	FAP17 (D)	FAP21 (E)	FAP30 (G)
Body size		3/8"	1/2"	5/8"	3/4"	1"	1-1/2"
GRD5ZN	23000 N	3	D		1	1	

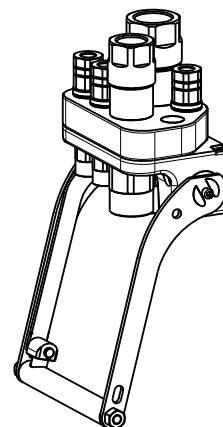

DRAWING



CONFIGURATIONS

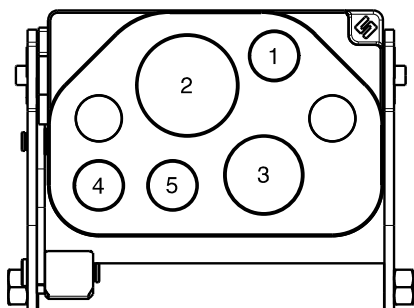

Possible configurations		
Pos	Coupling size	Predisposition for electrical connector
1	FAP9DZN	-
2	FAP21ZN	-
3	FAP17ZN	-
4	FAP9DZN	YES
5	FAP9DZN	YES

MultiCoupling (couplings included)

Code	Name	Description
870015066	MULTI COMPLETE GR5 2A-1D-1E	2 FAP9D 3/8 BSP - 1 FAP17 1 BSP - 1 FAP21 1-1/4 BSP - CAP
870015079	MULTI COMPLETE GR5 1A-1D-1E-1EC	1 FAP9D 3/8 BSP - 1 FAP17 3/4 BSP - 1 FAP21 1 BSP - 1EC6 - CAP
870015084	MULTI COMPLETE GR5 1D-1E-2EC	1 FAP17 3/4 BSP - 1 FAP21 1 BSP - 2EC6 - CAP
870015099	MULTI COMPLETE GR5 2A-1D-1E	2 FAP9D 3/8 BSP - 1 FAP17 3/4 BSP - 1 FAP21 1 BSP - CAP
870016000	MULTI COMPLETE GR5 3A-1D-1E	3 FAP9D 1/2 BSP - 1 FAP17 1 BSP - 1 FAP21 1-1/4 BSP - CAP
870016030	MULTI COMPLETE GR5 2A-1D-1E-1EC6	1 FAP9D 3/8 BSP - 1 FAP9D 1/2 BSP - 1 FAP17 1 BSP - 1 FAP21 1-1/4 BSP - 1EC6 - CAP
870016042	MULTI COMPLETE GR5 1A-1D-1E	1 FAP9D 3/8 BSP - 1 FAP17 1 BSP - 1 FAP21 1-1/4 BSP - CAP
870016043	MULTI COMPLETE GR5 2A-1E	2 FAP9D 3/8 BSP - 1 FAP21 1-1/4 BSP - CAP
870015161	MULTI FIX GR5 2A-1D-1E	2 FAP9D 1/2 BSP - 1 FAP17 1 BSP - 1 FAP21 1-1/4 BSP
870015184	MULTI FIX GR5 1D-1E-2EC	1 FAP17 3/4 BSP - 1 FAP21 1 BSP - 2EC6
870015166	MULTI FIX GR5 2A-1D-1E	2 FAP9D 3/8 BSP - 1 FAP17 1 BSP - 1 FAP21 1-1/4 BSP
870015199	MULTI FIX GR5 2A-1D-1E	2 FAP9D 3/8 BSP - 1 FAP17 3/4 BSP - 1 FAP21 1 BSP
870016130	MULTI FIX GR5 2A-1D-1E-1EC	1 FAP9D 3/8 BSP - 1 FAP9D 1/2 BSP - 1 FAP17 1 BSP - 1 FAP21 1-1/4 BSP - 1EC6
870016185	MULTI FIX GR5 2A-1D-1E-1EC	2 FAP9D 1/4 BSP - 1 FAP17 3/4 BSP - 1 FAP21 1-1/4 BSP - 1EC6
870015261	MULTI MOBILE GR5 2A-1D-1E	2 FAP9D 1/2 BSP - 1 FAP17 1 BSP - 1 FAP21 1-1/4 BSP
870015266	MULTI MOBILE GR5 2A-1D-1E	2 FAP9D 3/8 BSP - 1 FAP17 1 BSP - 1 FAP21 1-1/4 BSP
870015284	MULTI MOBILE GR5 1D-1E-2EC	1 FAP17 3/4 BSP - 1 FAP21 1 BSP - 2EC6
870015299	MULTI MOBILE GR5 2A-1D-1E	2 FAP9D 3/8 BSP - 1 FAP17 3/4 BSP - 1 FAP21 1 BSP
870016230	MULTI MOBILE GR5 2A-1D-1E-1EC	1 FAP9D 3/8 BSP - 1 FAP9D 1/2 BSP - 1 FAP17 1 BSP - 1 FAP21 1-1/4 BSP - 1EC6
870016285	MULTI MOBILE GR5 2A-1D-1E-1EC	2 FAP9D 1/4 BSP - 1 FAP17 3/4 BSP - 1 FAP21 1-1/4 BSP - 1EC6

MultiCoupling spare parts (couplings not included)

Code	Name
806000316	MULTI FIX EMPTY GR5 3A-1D-1E-2EC
806000317	MULTI MOBILE EMPTY GR5 3A-1D-1E-2EC
815606260	CAP FIX MULTICOUPLING GR 175x117 V02
815606261	PARKING STATION MOBILE MULTICOUPLING GR 180x120 V02
815701055	SPARE KIT LEVER GROUP GR 250x212

Custom configurations available upon request

Fixed and mobile multicoupling

5,6 Kg and 2,8 Kg

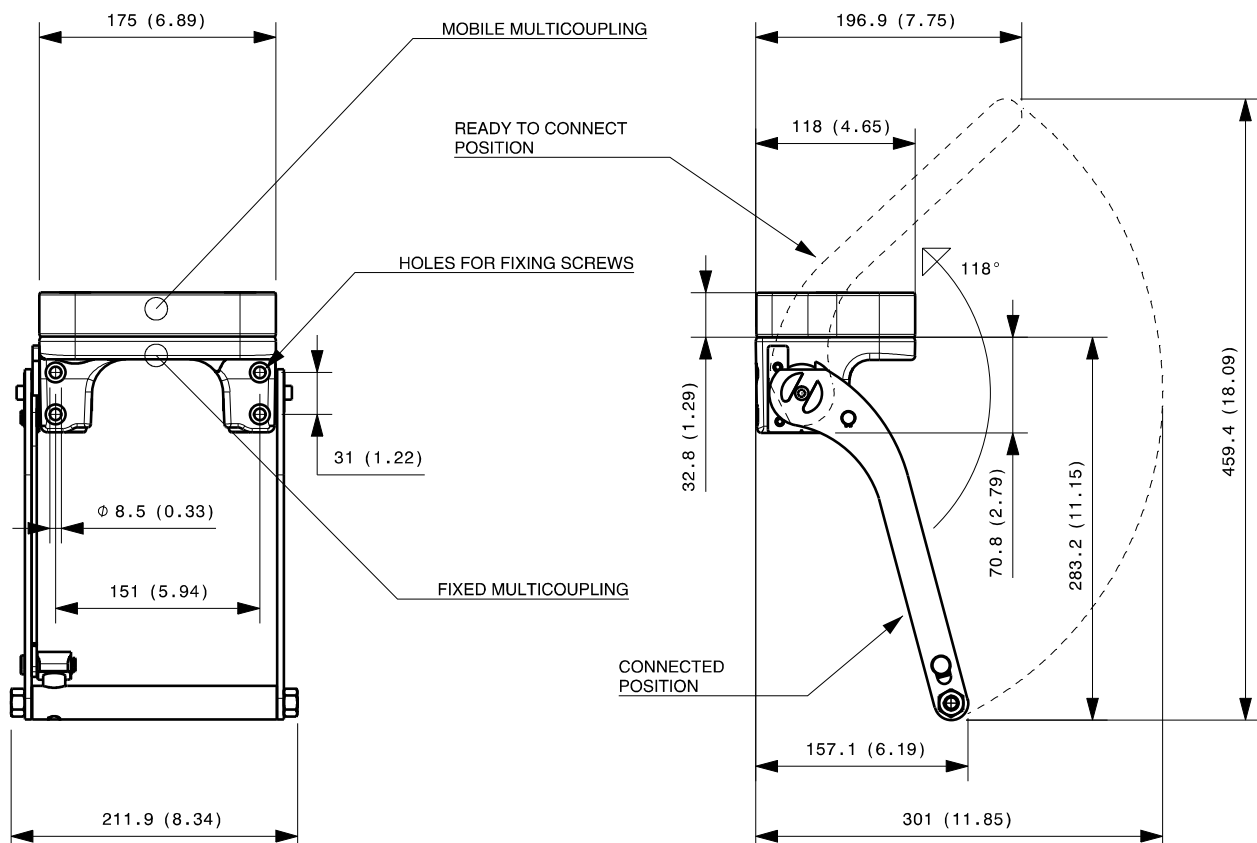

Dimensions in millimeters (inch)

Cap for fixed multicoupling 1,2 Kg

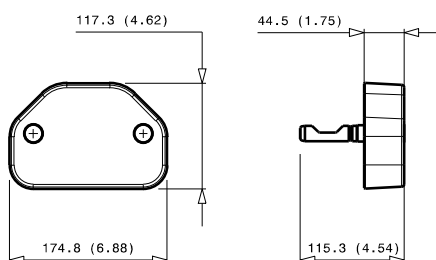

Parking station for mobile multicoupling 2,4 Kg

