

GR4 2A-2B-2EC

Previous description	Max. Resistance	FAP9 (A)	FAP13 (B)	FAP15 (C)	FAP17 (D)	FAP21 (E)	FAP30 (G)
Body size		3/8"	1/2"	5/8"	3/4"	1"	1-1/2"
GRB4ZN	18000 N	2 D	2				

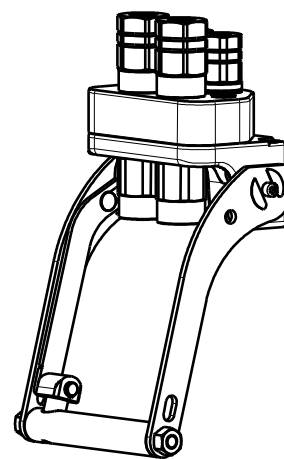

DRAWING



CONFIGURATIONS

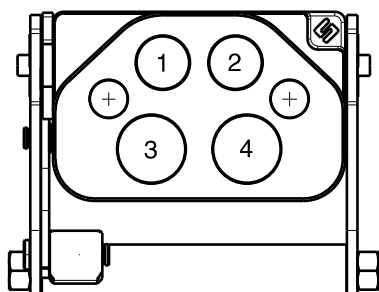

Possible configurations		
Pos	Coupling size	Predisposition for electrical connector
1	FAP9DZN	YES
2	FAP9DZN	YES
3	FAP13ZN	-
4	FAP13ZN	-

MultiCoupling (couplings included)		
Code	Name	Description
870016014	MULTI COMPLETE GR4 2A-2B	2 FAP9D 3/8 BSP - 2 FAP13 1/2 BSP - CAP
870016073	MULTI COMPLETE GR4 2A-1B	2 FAP9D 3/8 NPT - 1 FAP13 1/2 NPT - CAP
870016081	MULTI COMPLETE GR4 2B-2EC	1 FAP13 1/2 BSP - 1 FAQ13 1/2 BSP - 2EC7 - CAP
870016114	MULTI FIX GR4 2A-2B	2 FAP9D 3/8 BSP - 2 FAP13 1/2 BSP
870016214	MULTI MOBILE GR4 2A-2B	2 FAP9D 3/8 BSP - 2 FAP13 1/2 BSP

MultiCoupling spare parts (couplings not included)	
Code	Name
806000274	MULTI FIX EMPTY GR4 2A-2B-2EC
806000275	MULTI MOBILE EMPTY GR4 2A-2B-2EC
815606248	CAP FIX MULTICOUPLING GR 139x90
815606249	PARKING STATION MOBILE MULTICOUPLING GR 140x100
815701052	SPARE KIT LEVER GROUP GR 200x176

Custom configurations available upon request

Fixed and mobile multicoupling

3,7 Kg and 1,8 Kg

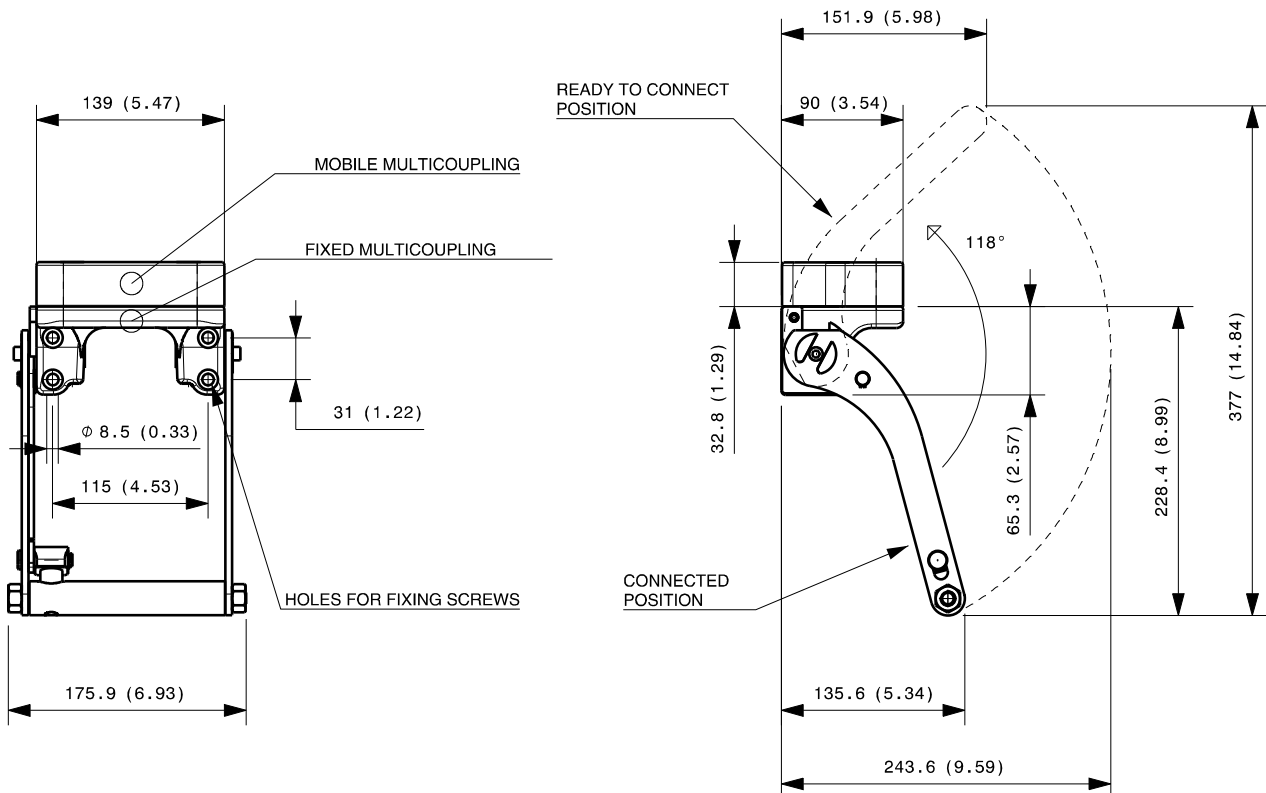

Dimensions in millimeters (inch)

Cap for fixed multicoupling 0,6 Kg

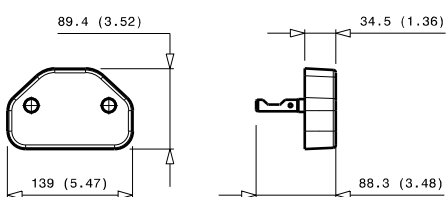

Parking station for mobile multicoupling 1,1 Kg

