

GR4 2A-1B-1D-2EC

Previous description	Max. Resistance	FAP9 (A)		FAP13 (B)	FAP15 (C)	FAP17 (D)	FAP21 (E)	FAP30 (G)
Body size		3/8"	D	1/2"	5/8"	3/4"	1"	1-1/2"
GR4MRZN	18000 N	2	D	1		1		

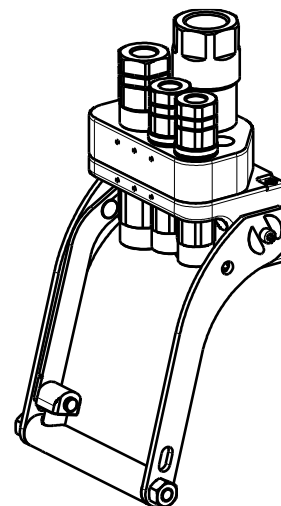

DRAWING



CONFIGURATIONS

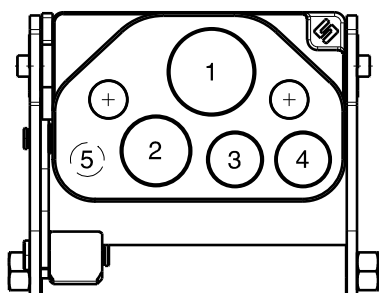

Possible configurations		
Pos	Coupling size	Predisposition for electrical connector
1	FAP17ZN	-
2	FAP13ZN	-
3	FAP9DZN	YES
4	FAP9DZN	YES
5		*

* - Holes Ø16 (0.63) for optional sensor.

MultiCoupling (couplings included)

Code	Name	Description
870016015	MULTI COMPLETE GR4 2A-1B-1D	2 FAP9D 3/8 BSP - 1 FAP13 1/2 BSP - 1 FAP17 1 BSP - CAP
870016115	MULTI FIX GR4 2A-1B-1D	2 FAP9D 3/8 BSP - 1 FAP13 1/2 BSP - 1 FAP17 1 BSP
870016215	MULTI MOBILE GR4 2A-1B-1D	2 FAP9D 3/8 BSP - 1 FAP13 1/2 BSP - 1 FAP17 1 BSP

MultiCoupling spare parts (couplings not included)

Code	Name
806000280	MULTI FIX EMPTY GR4 2A-1B-1D-2EC
806000281	MULTI MOBILE EMPTY GR4 2A-1B-1D-2EC
815606244	CAP FIX MULTICOUPLING GR 139x90 V01
815606249	PARKING STATION MOBILE MULTICOUPLING GR 140x100
815701052	SPARE KIT LEVER GROUP GR 200x176
815701300	KIT PLUG FOR HOLE D16 MULTI FIX GR4 2A-1B-1D-2EC

Fixed and mobile multicoupling

3,6 Kg and 1,7 Kg

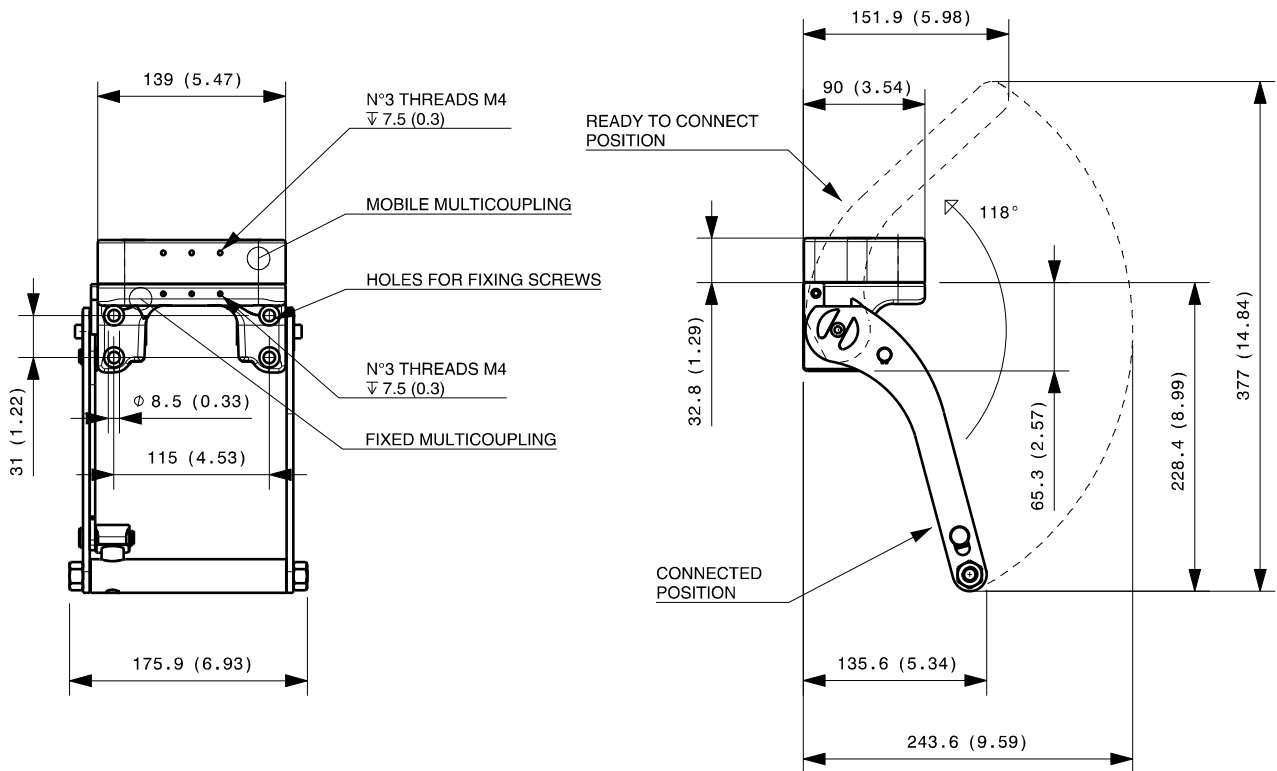

Dimensions in millimeters (inch)

Cap for fixed multicoupling 0,6 Kg

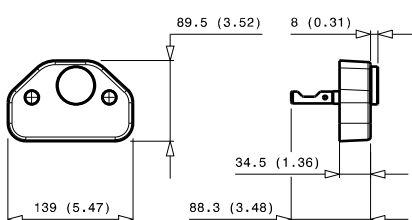

Parking station for mobile multicoupling 1,1 Kg

