

GR4 2A-1B-1C-2EC

Previous description	Max. Resistance	FAP9 (A)	FAP13 (B)	FAP15 (C)	FAP17 (D)	FAP21 (E)	FAP30 (G)
Body size		3/8"	1/2"	5/8"	3/4"	1"	1-1/2"
GRI4SBZN	18000 N	2 D	1	1			

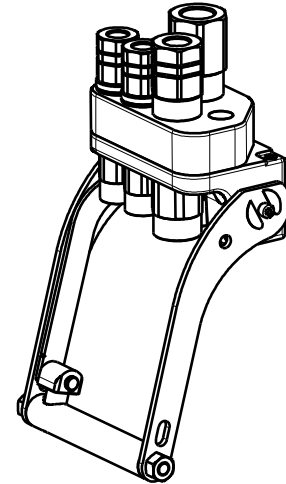

DRAWING



CONFIGURATIONS

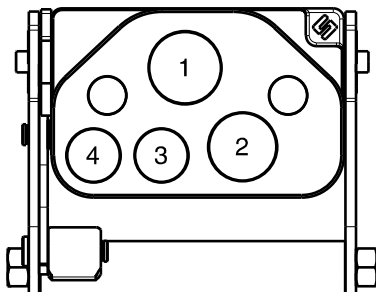

Possible configurations		
Pos	Coupling size	Predisposition for electrical connector
1	FAP15ZN	-
2	FAP13ZN	-
3	FAP9DZN	YES
4	FAP9DZN	YES

MultiCoupling (couplings included)		
Code	Name	Description
870015091	MULTI COMPLETE GR4 1B-1C	1 FAP13 1/2 BSP - 1 FAP15 3/4 BSP - CAP
870015191	MULTI FIX GR4 1B-1C	1 FAP13 1/2 BSP - 1 FAP15 3/4 BSP
870015291	MULTI MOBILE GR4 1B-1C	1 FAP13 1/2 BSP - 1 FAP15 3/4 BSP

MultiCoupling spare parts (couplings not included)	
Code	Name
806000276	MULTI FIX EMPTY GR4 2A-1B-1C-2EC
806000277	MULTI MOBILE EMPTY GR4 2A-1B-1C-2EC
815606246	CAP FIX MULTICOUPLING GR 139x90 V02
815606249	PARKING STATION MOBILE MULTICOUPLING GR 140x100
815701052	SPARE KIT LEVER GROUP GR 200x176

Custom configurations available upon request

Fixed and mobile multicoupling

3,7 Kg and 1,7 Kg

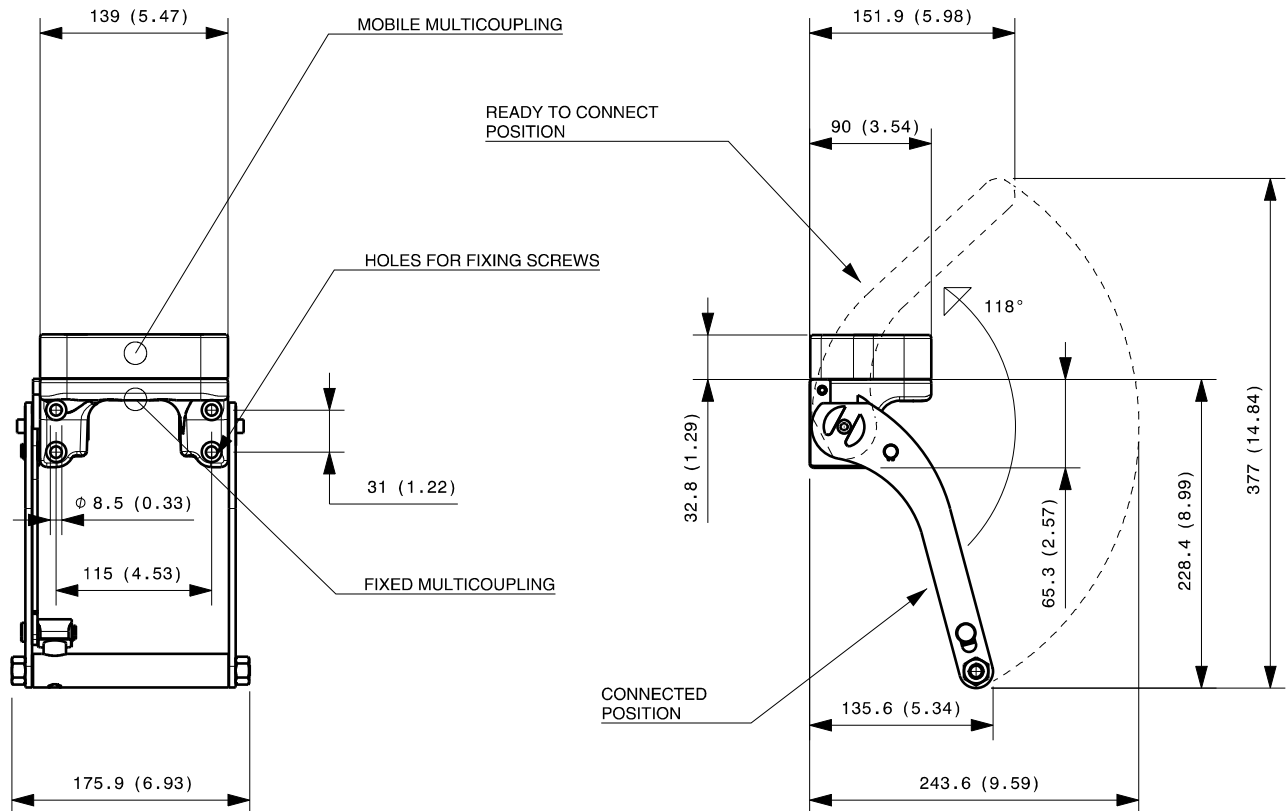

Dimensions in millimeters (inch)

Cap for fixed multicoupling 0,6 Kg

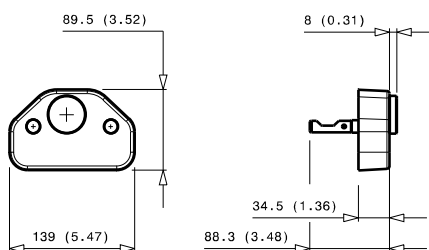

Parking station for mobile multicoupling 1,1 Kg

